

LED NEON FLEX

NDF1617

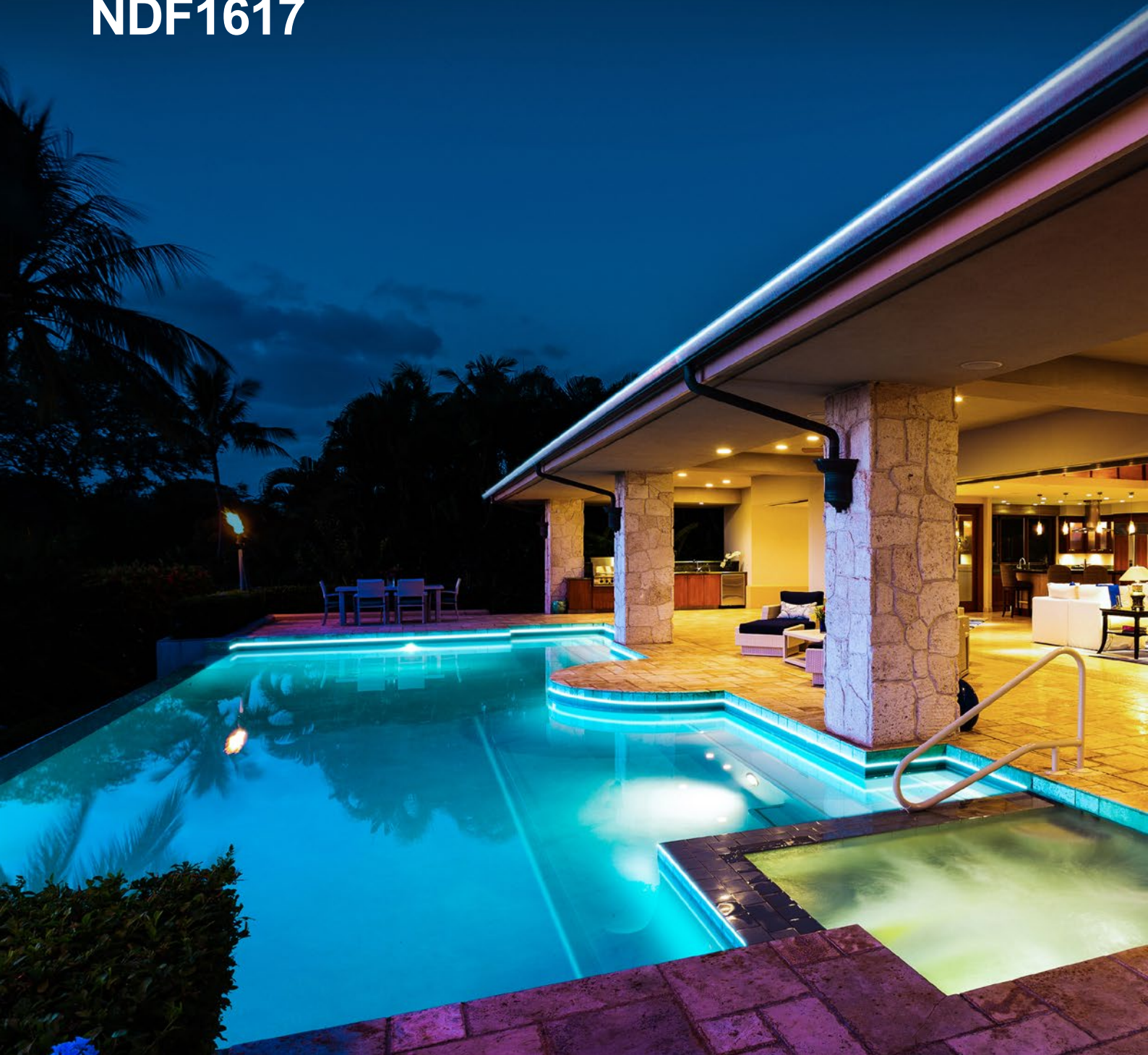



Features

- Color options: Single color, Tunable white and RGB.
Design: Superior design with exquisite craftsmanship ensure stable and reliable performance.
- Flexibility: Top bending, min. bend diameter 120mm[4.73inch].
- IP grade: Silicone extrusion, injection molded cap, IP67 protection. Glue process end caps, IP67 protection.
- Warranty: 5 years indoor, 3 years outdoor.
- Customization: multiple spec options, can be customized upon requirements.



Optical & Electrical Parameters

Model No.	NDF1617-Single color			NDF1617-WN		
CCT/Wavelength (K/nm)	3000K	4000K	6500K	6500K	2700K	W+N
Beam Angle (°)	113	113	113	113	113	113
Luminous Flux (lm/m)	1122	1150	1140	467	488	941
CRI	80+	80+	80+	80+	80+	80+
Efficacy (lm/W)	64.1	68.9	65.5	65.3	67.6	65.6
Voltage (V DC)	24	24	24	24	24	24
Measured Power (W/m)	17.28±10%	17.28±10%	17.28±10%	7.2±10%	7.2±10%	14.4±10%

Model No.	NDF1617-RGB			
CCT/Wavelength (K/nm)	Red	Green	Blue	100000K
Beam Angle (°)	113	113	113	113
Luminous Flux (lm/m)	89	203	46	317
CRI	--	--	--	--
Efficacy (lm/W)	17.6	35.0	7.8	19.0
Voltage (V DC)	24	24	24	24
Measured Power (W/m)	5.76±10%	5.76±10%	5.76±10%	5.76±10%

Model No.	NDF1617-PIXEL			
CCT/Wavelength (K/nm)	Red	Green	Blue	RGBW: 2300-6500
Beam Angle (°)	113	113	113	113
Luminous Flux (lm/m)	48	110	25	178
CRI	--	--	--	--
Efficacy (lm/W)	7.2	15.8	3.5	12.6
Voltage (V DC)	24	24	24	24
Measured Power (W/m)	4.32±10%	4.32±10%	4.32±10%	14.2±10%

Model No.	NDF1617-RGBW				
CCT/Wavelength (K/nm)	6500K	Red	Green	Blue	RGBW: 2300-6500
Beam Angle (°)	113	113	113	113	476
Luminous Flux (lm/m)	--	61	142	33	445
CRI	--	--	--	--	--
Efficacy (lm/W)	--	12.2	28.4	6.6	25.0
Voltage (V DC)	24	24	24	24	24
Measured Power (W/m)	4.32±10%	4.32±10%	4.32±10%	4.32±10%	17.28±10%

Other Parameters

Model No.	NDF1617-Single color	NDF1617-WN	NDF1617-RGB	NDF1617-PIXEL	NDF1617-RGBW
LED QTY (pcs/m)	112	240	72	60	72
Product Size L*W*H (mm)	10000*16*17	10000*16*17	5000*16*17	10000*16*17	5000*16*17
Standard Run Length (mm)	10000	10000	5000	10000	5000
Min. Cuttable Length (mm)	62.5	50	83.33	100	83.33
Working Temperature	-20~+60°C	-20~+60°C	-20~+60°C	-20~+60°C	-20~+60°C
Storage Temperature	-20~+70°C	-20~+70°C	-20~+70°C	-20~+70°C	-20~+70°C

Note:

The given data are typical values. Due to tolerances of the production process and the electrical components, values for light output and electrical power can vary up to 10%.

Profile Drawings

Unit: mm[inch]

Glue Process (IP67)

Injection Moulded (IP68)

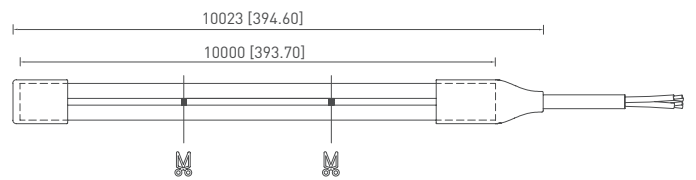
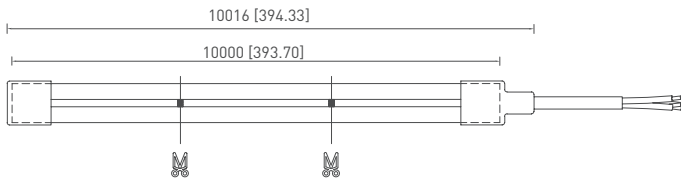

Bend direction

Bending Diameter

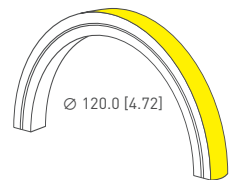
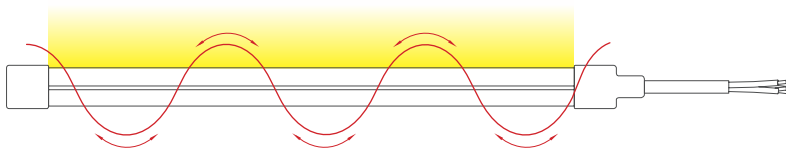

Sectional view

Front cap

Closing End-cap

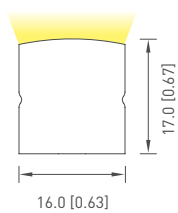

Glue Process (IP67)

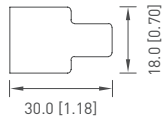

Glue Process (IP67)

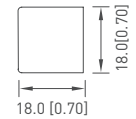

Injection Moulded (IP67)

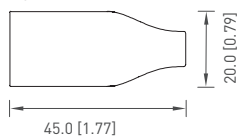

Injection Moulded (IP67)

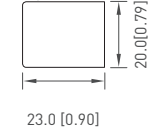

Remarks: "L" is the standard size of the light strip, can be customized according to the multiple of the minimum cutting unit length.

IP Process Technology

Injection Moulded (IP67)

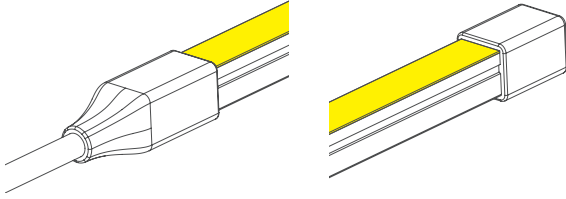

Glue Process (IP67)

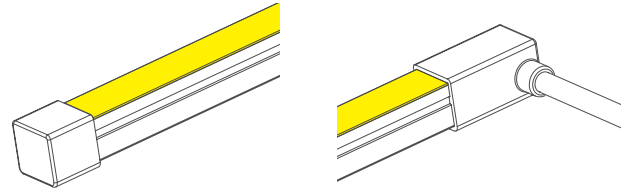



- After cutting, the IP protection of both glue processed and injection moulded product will drop to IP65, for injection moulded product, if customer self-processed injection moulded end cap for the cutted end, the IP protection will keep the IP68 level.
- Injection moulded end cap self-processing, need to prepare corresponding mold and molding equipment.
- If the customer reprocesses Blueview injection moulded end cap, and the waterproof of the molded end does not meet Blueview standard, the potential troubles are not covered by the warranty.

Product accessories

Item	Model No.	Dimensions (L*W*H)mm	Quantity (m)/pcs	Free/Optional
Front cap (Injection Moulded)	NDF1617-PCIIM	45.0*19.2*20.2	(5/10): 5/10	Optional
Closing End-cap (Injection Moulded)	NDF1617-ECIM	23.0*19.2*20.2	(5/10): 5/10	Optional
Front cap	NDF1617-PCIS	30.0*18.0*18.0	(5/10): 3/6	Free
Closing End-cap	NDF1617-ECS	18.0*19.0*18.0	(5/10): 3/6	Free
Front cap(Side)	NDF1617-PCBS	25.0*30.0*19.0	(5/10): 3/6	Optional
3.5cm Aluminum track	NDF1617-AMC	35.0*21.2*19.0	(5/10): 5/10	Optional
Aluminum Channel	NDF1617-AC	1000*19.3*18.7	(5/10): 3/6	Optional

Product accessories

Item	Model No.	Dimensions (L*W*H)mm	Quantity (m)/pcs	Free/Optional	
	S-type Track	NDF1617-ACS	500*17.2*17.8	(5/10): 5/10	Optional
	Screws	--	----	NDF1617-AMC:2pcs/piece NDF1617-AC:3pcs/piece NDF1617-MC:1pcs/piece NDF1617-ACS:2pcs/piece	Optional
	Silicone Glue	--	----	(5/10/15): 1	Optional

Luminous Intensity Distribution Diagram

Average Illumination

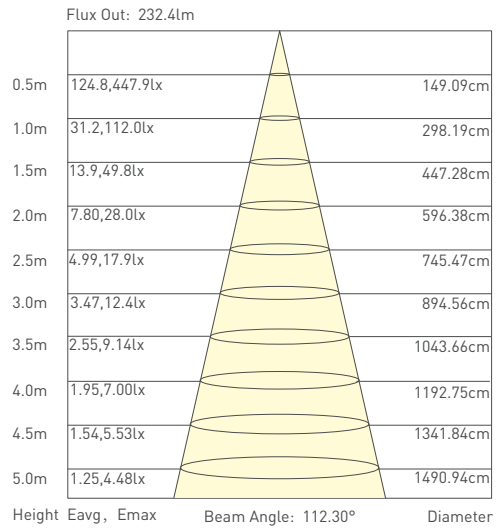
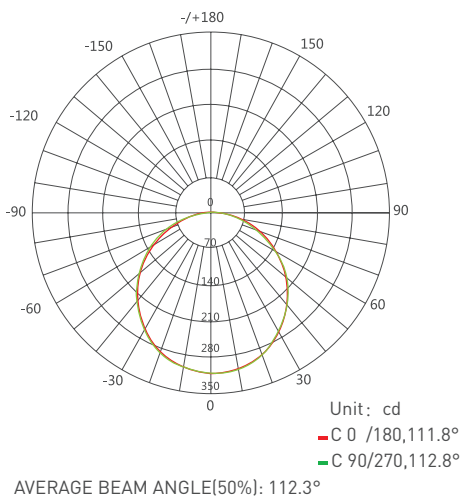

Note: the above two figures are tested with the sample NDF1617-WN, for other data, please consult sales, rep.

Packaging information

Model No.	NDF1617-W	NDF1617-WN	NDF1617-RGB	Pixel	NDF1617-RGBW
Product Size L*W*H (mm)	10000*16*17	10000*16*17	5000*16*17	10000*16*17	5000*16*17
Carton Size (mm)	390*390*325	390*390*325	390*390*325	390*390*325	390*390*325
Meter/Reel	10	10	5	10	5
Reel/Carton	3	5	10	2	10
Net Weight (kg)	9.25 (1± 10%)	15.05 (1± 10%)	15.5 (1± 10%)	9.2 (1± 10%)	15.15 (1± 10%)
Gross Weight (kg)	12.5 (1± 10%)	19.45 (1± 10%)	20.15 (1± 10%)	12.45 (1± 10%)	16.95 (1± 10%)

Note: the volume weight is 9.89kg.

Recommended power supply upon working length

Model No.	NDF1617-W			NDF1617-WN		
	1	5	10	1	5	10
Working Length (m)	1	5	10	1	5	10
Rated Current (A)	0.72	3.6	7.2	0.6	3	8
Rated Voltage (DC V)	24	24	24	24	24	24
Rated Power (W)	17.28	86.4	172.8	14.4	72	144
Recommended Power Supply (W)	30	100	250	25	100	200
Power Supply Mode	Single Feed	Single Feed	Single Feed	Single Feed	Single Feed	Single Feed

Model No.	NDF1617-RGB		Pixel			NDF1617-RGBW	
	1	5	1	5	10	1	5
Working Length(m)	1	5	1	5	10	1	5
Rated Current (A)	0.72	3.6	0.54	2.7	5.4	0.72	3.6
Rated Voltage (DC V)	24	24	24	24	24	24	24
Rated Power (W)	17.28	86	12.96	64.8	129.6	17.28	86.4
Recommended Power Supply (W)	30	120	20	80	150	30	150
Power Supply Mode	Single Feed	Single Feed	Single Feed	Single Feed	Single Feed	Single Feed	Single Feed

BLUEVIEW ELEC-OPTIC TECH CO.,LTD
 Tel: +86-28-8148 0011 Fax: +86-28-8148 1258
 Mail: sales@blueviewled.com
 Web.: www.blueviewled.com
 Add.: No.1000, Konggang 2nd Konggang Road, Southwest Aviation
 Industrial Zone, Chengdu, China. 610207